

PNEUMATIC BALL VALVE

(ORDERING INFORMATION)

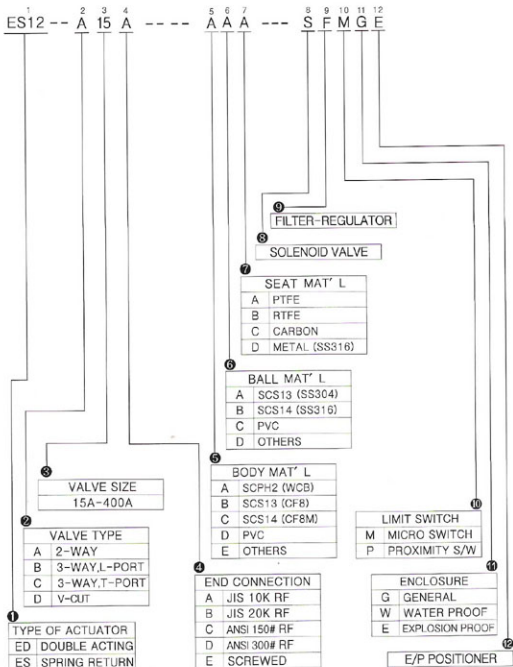

PNEUMATIC ACTUATOR & VALVE

2-WAY FLANGED BALL VALVE (DOUBLE ACTING ACTUATOR)

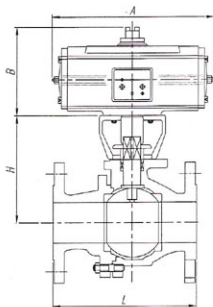
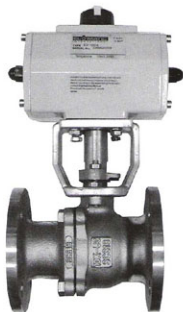

NOTE : 1) DOUBLE ACTING TYPE
2) ACC'Y OPTION : SOLENOID VALVE,
LIMITS/W BOX, AIR SET
** DIMENSION / STANDARD MODEL

Specifications

-Actuator

- pressure 0.2to 10 bar
- temperature -20°C to +80°C
- rotation 91.5° (0.5° cw to 91° ccw)
- materials casing : aluminium alloy
shaft : high-grade aluminium alloy
- finish 2-component polyurethane
- service life one million operations, minimum

PART NAME	MATERIAL
BODY	SCS 13
BALL	SCS 13
STEM	SUS 304
SEAT	PTFE
CONNECTION	JIS 10K RF

MODEL	SIZE	H	B	L	A
ED 25	15A	120	100	108	159
ED 25	20A	126	100	117	159
ED 25	25A	134	100	127	159
ED 40	32A	152	113	140	180
ED 65	40A	162	125	165	199
ED 100	50A	185	138	178	221
ED 100	65A	190	138	190	221
ED 200	80A	241	165	203	283
ED 200	100A	259	163	229	283
ED 350	125A	337	201	356	305
ED 600	150A	362	250	394	387
ED 1600	200A	433	327	457	516
PD 2500	250A	469	386	533	378

PNEUMATIC ACTUATOR & VALVE

2-WAY FLANGED BALL VALVE (SPRING RETURN ACTUATOR)

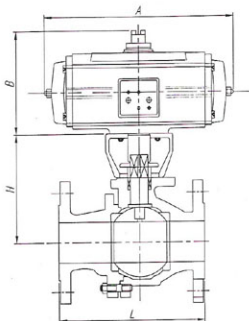

NOTE: 1) SINGLE ACTING TYPE
2) ACC'Y OPTION: SOLENOID VALVE,
LIMIT S/W BOX, AIR SET
** DIMENSION / STANDARD MODEL

Specifications

- Actuator

- pressure 0.2 to 10 bar
- temperature -20°C to +80°C
- rotation 91.5° (0.5° cw to 91° ccw)
- materials casing : aluminium alloy
shaft : high-grade aluminium alloy
- finish 2-component polyurethane
- service life one million operations, minimum

PART NAME	MATERIAL
BODY	SCS 13
BALL	SCS 13
STEM	SUS 304
SEAT	PTFE
CONNECTION	JIS 10K RF

MODEL	SIZE	H	B	L	A
ES 40	15A	120	113	108	204
ES 40	20A	126	113	117	204
ES 40	25A	134	113	127	204
ES 65	32A	152	125	140	249
ES 100	40A	162	138	165	267
ES 200	50A	185	138	178	267
ES 350	65A	190	163	190	360
ES 350	80A	241	201	203	387
ES 350	100A	259	201	229	387
ES 600	125A	337	250	356	477
ES 950	150A	362	289	394	517
ES 1600	200A	433	327	457	637
PS 2500	250A	469	386	533	570

PNEUMATIC ACTUATOR & VALVE

3-WAY FLANGED BALL VALVE (DOUBLE ACTING ACTUATOR)

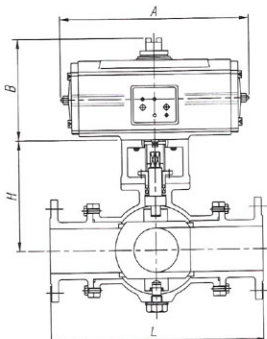
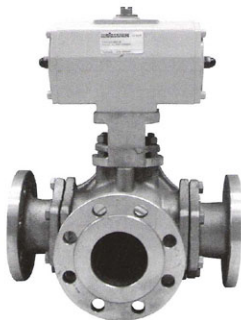

Specifications

-Actuator

- pressure 0.2 to 10 bar
- temperature -20°C to +80°C
- rotation 91.5° (0.5° cw to 91° ccw)
- materials casing : aluminium alloy
shaft : high-grade aluminium alloy
- finish 2-component polyurethane
- service life one million operations, minimum

PART NAME	MATERIAL
BODY	SCS 13
BALL	SCS 13
STEM	SUS 304
SEAT	PTFE
CONNECTION	JIS 10K RF

NOTE : 1) DOUBLE ACTING TYPE
2) ACC'Y OPTION : SOLENOID VALVE,
LIMIT S/W BOX, AIR SET
** DIMENSION / STANDARD MODEL

MODEL	SIZE	H	B	L	A
ED 25	15A	138	100	180	159
ED 25	20A	145	100	190	159
ED 25	25A	155	100	200	159
ED 65	40A	180	125	240	199
ED 100	50A	205	138	260	221
ED 100	65A	228	138	320	221
ED 200	80A	279	163	360	283
ED 200	100A	326	163	430	283
ED 350	125A	394	201	520	305
ED 600	150A	424	250	560	387
ED 1600	200A	501	327	660	516

PNEUMATIC ACTUATOR & VALVE

3-WAY FLANGED BALL VALVE (SPRING RETURN ACTUATOR)

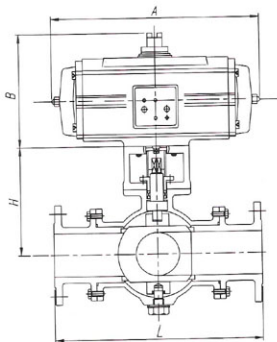
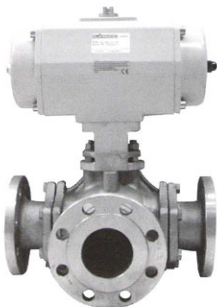

NOTE : 1) SINGLE ACTING TYPE
2) ACC'Y OPTION : SOLENOID VALVE,
LIMIT S/W BOX, AIR SET
** DIMENSION / STANDARD MODEL

Specifications

-Actuator

- pressure 0.2to 10 bar
- temperature -20°C to +80°C
- rotation 91.5° (0.5° cw to 91° ccw)
- materials casing : aluminium alloy
shaft : high-grade aluminium alloy
- finish 2-component polyurethane
- service life one million operations,
minimum

PART NAME	MATERIAL
BODY	SCS 13
BALL	SCS 13
STEM	SUS 304
SEAT	PTFE
CONNECTION	JIS 10K RF

MODEL	SIZE	H	B	L	A
ES 40	15A	138	113	180	204
ES 40	20A	145	113	190	204
ES 40	25A	155	113	200	204
ES 100	32A	180	138	240	267
ES 100	40A	205	138	260	267
ES 200	50A	228	163	320	360
ES 350	65A	279	201	360	387
ES 350	80A	326	201	430	387
ES 600	100A	394	250	520	477
ES 950	125A	424	289	560	517
ES 1600	150A	501	327	660	637